

Hilmer Outfall  
Fly TIES

Western  
outdoor man

FOR  $\frac{2723}{2723}$

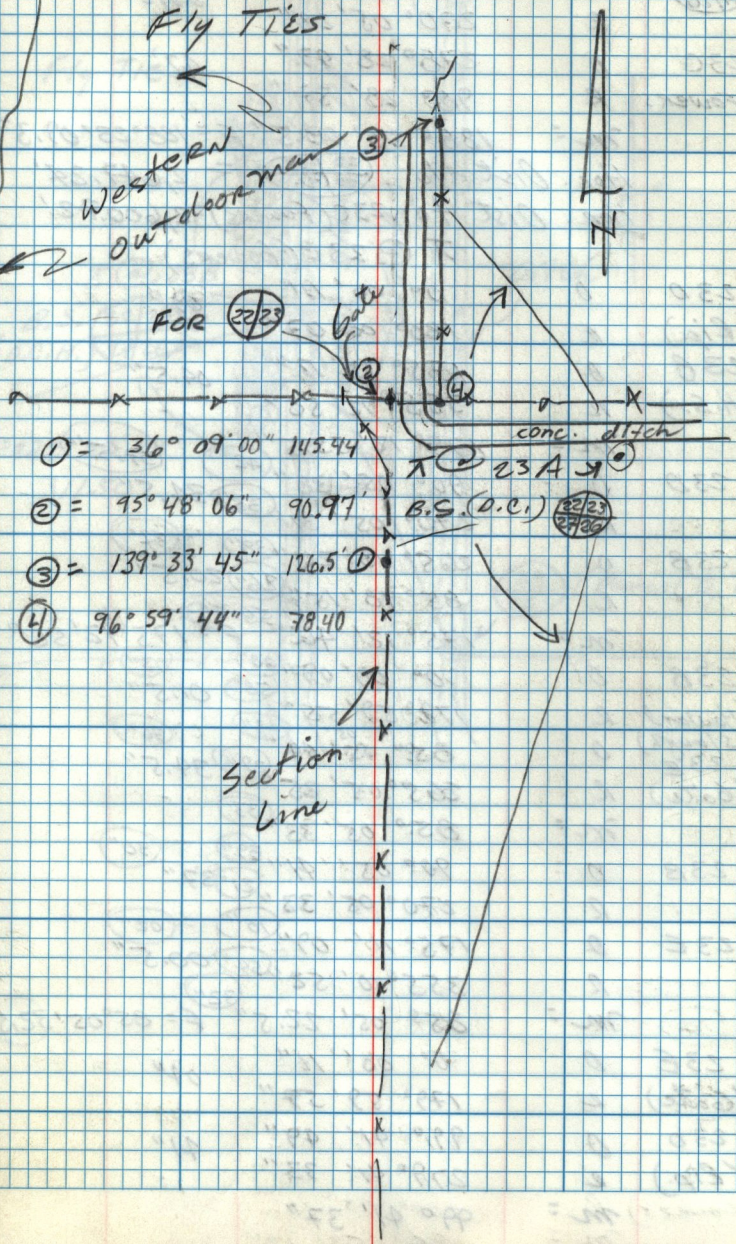

① =  $36^{\circ} 09' 00''$  145.44

② =  $45^{\circ} 48' 06''$  90.97

③ =  $139^{\circ} 33' 45''$  126.5

④ =  $96^{\circ} 59' 44''$  78.40

Section  
Line

B.S. (D.C.)  $\frac{2723}{2723}$

conc. ditch